

# The Development of the Farm

## FIFTH PHASE: A WERF DIVIDED

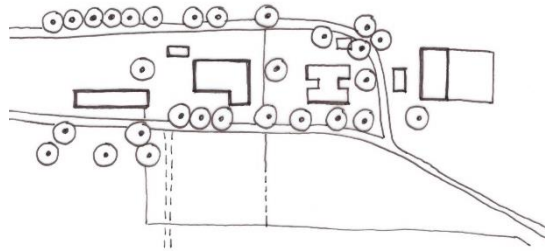

The Malan family owned the farm from 1885 to 1918. Jacobus Francois Malan sub-divided the farm for his two sons, Daniël Bortholomeus and Jacobus Francois, in 1910 (T7091/7092 of 1910). This subdivision drew a line through the centre of the farm werf, thereby creating the farm Klein Diamant, with the large northern barn/ wine cellar/"The Venue" (a portion of which was used as stables by then) and the "Pioneers House" (Malan converted the stables back to a house and affected "Victorian" stylistic changes to the house), towards the north and the farm Groot Diamant with the H-plan homestead ("The Manor House"), its small outbuildings and the old barn ("The Chapel and The Barn") and kraal towards the south. The descendants of Daniël Bortholomeus Malan continued to live on Klein Diamant, while Groot Diamant was sold by Jacobus Francois Malan in 1918 to the Hugo family.